

Jet™



Express Starter Kit

User's Guide

How It Works

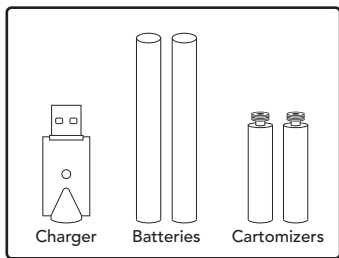

Your Jet Express Starter Kit contains two Jet batteries, two Jet 22mg cartomizers (one Perique Tobacco and one Mojito Mint), and one USB charger.

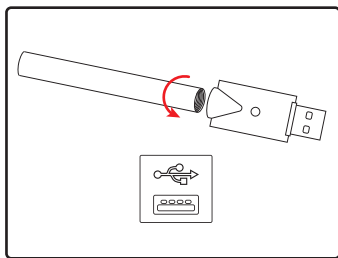

Charge your battery by screwing it into the USB charger, then plugging the charger into a USB port on a computer or wall charger. The LED on the battery will turn on. Fully charging the battery takes about 1 to 2 hours. The light on the USB charger will turn from red to green when the battery is fully charged.

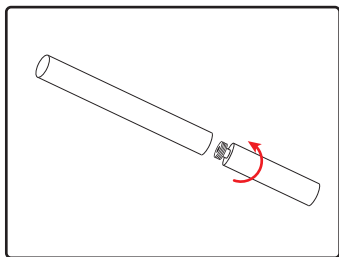

After the battery is charged, unscrew it from the charger, then attach a cartomizer by screwing it into the battery. The cartomizer should be screwed on until it's "snug" – don't over-tighten!

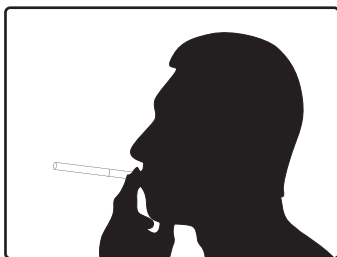

Draw on the electronic cigarette to begin vaping!

Device Notes

BATTERY

If a battery is depleted of charge, the LED will blink ten times when it is drawn upon, and no vapor will be produced by the device. At this point, the battery must be recharged in the USB charger before further use.

The amount of vapor produced by the electronic cigarette will decline as battery charge is depleted.

Do not take too many consecutive puffs, especially with a fully charged battery, as this could shorten the life of the cartomizer.

CARTOMIZERS

Do not draw on a cartomizer unless it is attached to a charged battery.

Don't remove the sticker from the top of a cartomizer until you are ready to begin vaping. This will ensure maximum flavor quality out of your device.

Discontinue use of the cartomizer if vapor production is no longer adequate, or if you experience an unpleasant taste. Jet cartomizers are not designed to be refilled.

CHARGER

The USB charger should be detached from your computer, or other USB port, before the battery is screwed or unscrewed.

Frequently Asked Questions

Q: Is Jet a smoking cessation product?

A: No. Jet has not been tested or proven to be a smoking cessation device and is not marketed or sold as one.

Q: How do I turn my battery on?

A: Your battery will automatically activate when it detects a user drawing on the e-cigarette. There are no on or off buttons to worry about – if it's charged, it will produce power when drawn upon.

Q: Can I use Jet anywhere?

A: Check your local rules. Electronic cigarettes are permitted in many, but not all,

places where regular cigarettes are banned.

Q: What are the ingredients in Jet?

A: Jet contains five major ingredients: USP glycerin, USP propylene glycol, distilled water, flavors, and nicotine.

Please see the "FAQ" tab on our web site for more frequently asked questions.

Warning

This is not a smoking cessation product.

Jet products are an alternative to traditional cigarettes, and are not intended to diagnose, cure, mitigate, treat, or prevent any disorder, disease, or physical or mental condition. The FDA has not approved Jet products for any use.

Jet products contain nicotine. Nicotine is addictive, habit forming, and toxic, and is a chemical known to the State of California to cause birth defects or other reproductive harm. Ingestion of the non-vaporized concentrated ingredients in the cartomizers can be poisonous. Physical effects of nicotine may include increased heart rate and blood pressure.

Jet products are intended for use by adults of legal smoking age, and should not be used by children, women who are pregnant or breast feeding, persons with or at risk of heart disease, high blood pressure, or diabetes, or persons taking medicine for depression or asthma. Keep out of reach of children and pets. In case of improper ingestion, contact your local poison control center and seek immediate medical attention.

Limited Warranty

Jet products are guaranteed against defects in workmanship and materials, if purchased from Jet or an authorized Jet dealer, for 12 months from the date of purchase.

**PARTS REPLACEMENT ONLY
NO REFUNDS**

Return **ONLY** the defective parts to:
Jet Cigs LLC
777 Henderson Blvd.
Park Sq. South Bldg., Bay 1A
Folcroft, PA 19032

Pack the part securely and obtain insurance. Describe the defect, send return address, phone number, and copy of proof of purchase. Jet not responsible for damage or loss caused during transit.

Warranty does not apply to cartomizers.

www.**jet**cigs.com